

PUSH-IN FITTINGS XVR SERIES



PLUS

Suitable for **USE IN AGGRESSIVE ENVIRONMENTS** and **IN CRITICAL CONDITIONS**

Suitable for **PERMANENT FOOD CONTACT APPLICATIONS**

OPTIMIZED DESIGN WITH COMPACT DIMENSIONS

PRODUCTS CAN BE TAILOR-MADE TO SPECIFIC CUSTOMER NEEDS



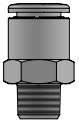

p. 103 / **XVRC-R**

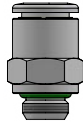

p. 103 / **XVRC-G**



p. 103 / **XVROC-G**

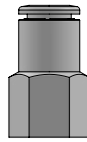

p. 104 / **XVRCF-G**

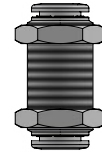

p. 104 / **XVRMM**

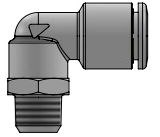

p. 104 / **XVRL-R**

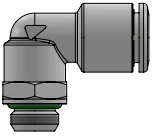

p. 105 / **XVRL-G**

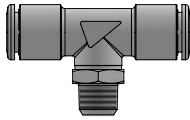

p. 105 / **XVRT-R**

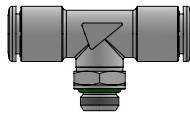

p. 105 / **XVRT-G**

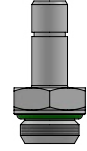

p. 106 / **XVRA-G**

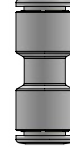

p. 106 / **XVRUC**

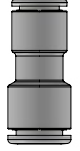

p. 106 / **XVRG**

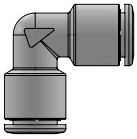

p. 107 / **XVRUL**

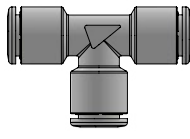



p. 107 / **XVRUT**



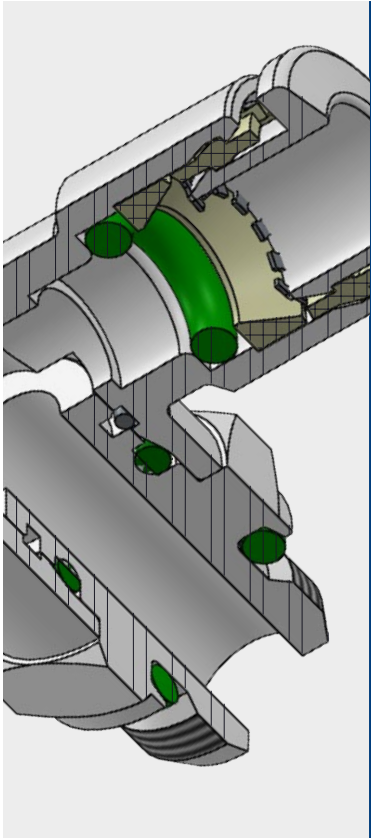

p. 107 / **XVRGJ**







 -20°C ÷ 150°C

 **Working pressure:**
20 Bar
Negative pressure:
- 0,95 Bar (- 95 kPa)

 Compressed air, vacuum, water and fluids suitable with the construction materials

 - Taper gas BSPT ISO 7 from R1/8" to R1/2"
- Parallel gas BSPP ISO 228 from G1/8" to G1/2"
- Metric ISO 262 M5 and M7

 Polyamide PA, polyethylene PE, FEP, PTFE and stainless steel tube with groove (see the table)



NSF/ANSI 169



Food contact materials EC 1935/2004



D.M. 174/2004



ICIM certified product food contact materials



ICIM certified product water contact materials

SILICONE FREE



Products in compliance with EC Regulation 1907/2006



Products in compliance with the directive EU 2015/863

- Body: Stainless steel AISI 316L
- Collet: Stainless steel AISI 316L
- Back ring: PVDF-UHM FDA compliant
- O-ring: FKM NSF/ANSI 61 certified and FDA compliant
- Seal: FKM NSF/ANSI 61 certified and FDA compliant
- Lock claw: Stainless steel AISI 301
- Collar: PVDF-UHM FDA compliant
- Retaining ring for swivel system: Stainless steel AISI 302

PIPE GROOVE - HARD METALLIC TUBE

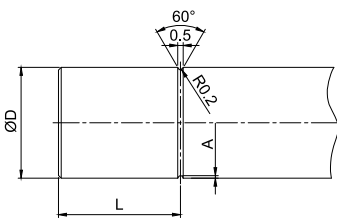

When using metallic tubes, please deburr the tubes ends to avoid potential cutting or other damages to the O-ring.

ØD (mm)	L (mm)	A (mm)
4	7,6	0,23
6	8,0	0,23
8	9,0	0,23
10	11,0	0,23
12	12,7	0,23

CONSTRUCTION DETAILS

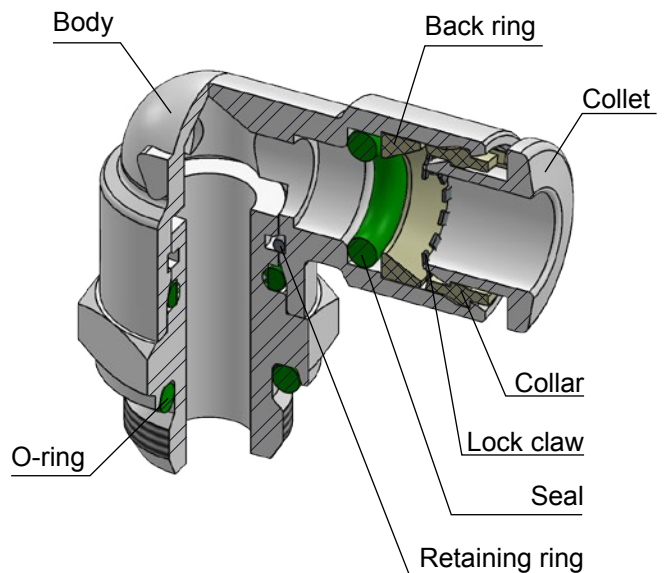

drawings and technical data are not binding & can be changed without notice

Subject to change

INSERTION OF THE TUBE INTO THE FITTING

- Make sure the tube is fully inserted into the fitting.
- To insert the tube into the fitting cut the tube off square (90°), insert tube up to the fitting end stop, and pull back gently to make sure it is correctly connected.
- If there is any damage or scratches on the tube surface the tube is an oval shape, air leakage and tube release may occur. Check the tube condition carefully.
- The OD of polyurethane tube expands when pressure is applied. Reinsertion into the fitting may not always be possible. Check the OD of the tube and renew it the expansion is out of tolerance.

DISCONNECTION OF THE TUBE FROM THE FITTING

- Make sure the pressure in the system is zero before releasing the tube from the fitting.
- To release the tube, press the release sleeve towards the fitting with one hand (1) and pull the tube away from the fitting with the other hand (2).
- Always remove the section of tube previously inserted into the fitting before reinserting the tube by cutting back the tube. Always use the correct tube cutter in order to cut the tube square and free of damage.

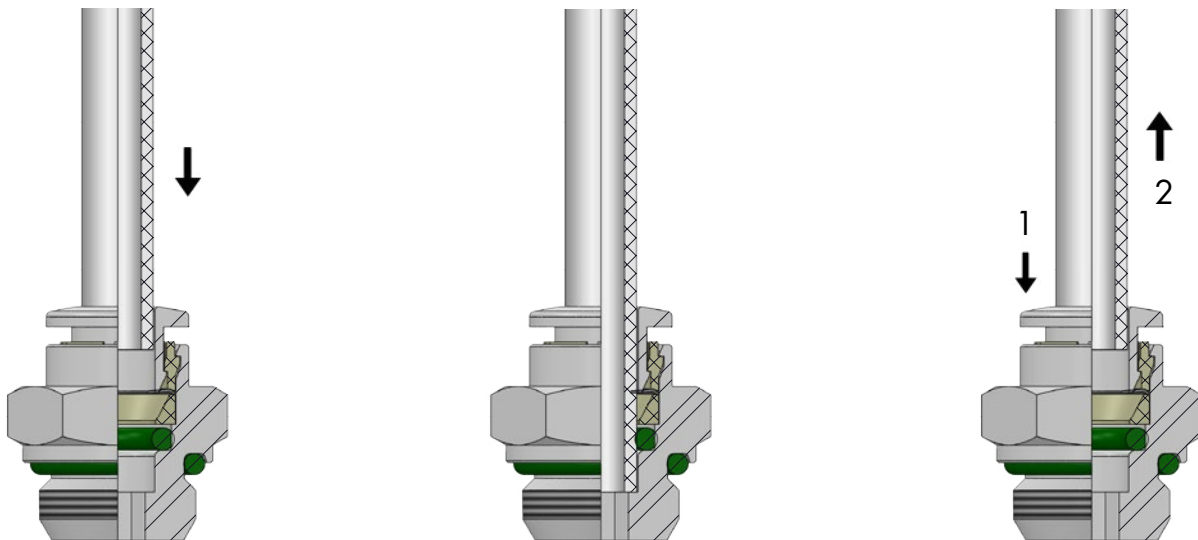

TOLERANCES - METRIC TUBE

Ø TUBE (mm)	4	6	8	10	12
TOLERANCE (mm)	± 0,1	± 0,1	± 0,1	± 0,15	± 0,15

INSERTION DEPTH - METRIC TUBE

Ø TUBE (mm)	4	6	8	10	12
TUBE INSERTION LENGTH (mm)	14	15,5	17,5	19	21

TIGHTENING TORQUE TAPER GAS BSPT ISO 7

THREAD	1/8"	1/4"	3/8"	1/2"
Nm	10-12	14-16	16-18	18-20

TIGHTENING TORQUE PARALLEL GAS BSPP ISO 228 & METRIC ISO 262

THREAD	M5x0,8	M7x1	1/8"	1/4"	3/8"	1/2"
Nm	1 ± 20%	3 ± 20%	6 ± 20%	7,5 ± 20%	9 ± 20%	9 ± 20%



XVRC-R

Male connector BSPT thread

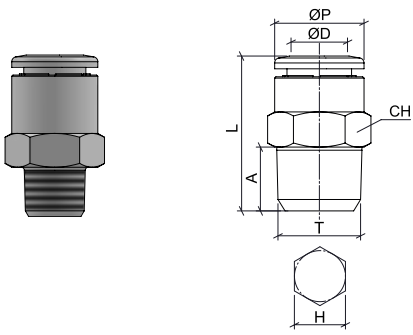

CODE	ØD	T	ØP	A	L	CH	H
XVRC04R01	4	R 1/8"	10	8	18,5	10	3
XVRC04R02		R 1/4"	10	10	20	14	3
XVRC06R01	6	R 1/8"	12	8	21	12	4
XVRC06R02		R 1/4"	12	10	20,5	14	4
XVRC08R01	8	R 1/8"	14	8	26	14	5
XVRC08R02		R 1/4"	14	10	24	14	6
XVRC08R03		R 3/8"	14	11	22	17	6
XVRC10R02	10	R 1/4"	16	10	31	16	7
XVRC10R03		R 3/8"	16	11	26	17	8
XVRC12R02	12	R 1/4"	19	10	33	19	7
XVRC12R03		R 3/8"	19	11	29,5	19	10
XVRC12R04		R 1/2"	19	14	27	22	10

XVRC-G

Male connector BSPP & metric thread

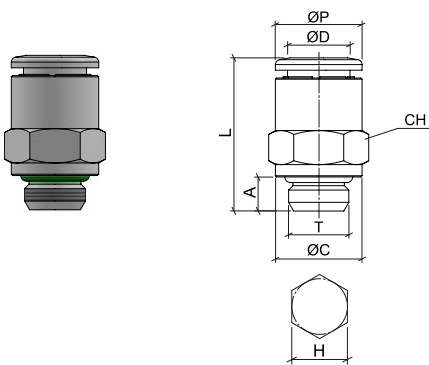

CODE	ØD	T	ØP	ØC	A	L	CH	H
XVRC04M5	4	M5x0,8	10	7	4	19	10	2,5
XVRC04G01		G 1/8"	10	13	5,5	18	13	3
XVRC04G02		G 1/4"	10	16	6,5	18	16	3
XVRC06M5	6	M5x0,8	12	7	5	21	12	2,5
XVRC06G01		G 1/8"	12	13	5,5	19,5	13	4
XVRC06G02		G 1/4"	12	16	6,5	19,5	16	4
XVRC08G01	8	G 1/8"	14	14	5,5	24,5	14	5
XVRC08G02		G 1/4"	14	16	6,5	21,5	16	6
XVRC08G03		G 3/8"	14	20	7,5	21,5	20	6
XVRC10G02	10	G 1/4"	16	16	6,5	27,5	16	7
XVRC10G03		G 3/8"	16	20	7,5	25	20	8
XVRC12G02	12	G 1/4"	19	16	6,5	30	19	7
XVRC12G03		G 3/8"	19	22	7,5	29,5	22	10
XVRC12G04		G 1/2"	19	25	9	28	25	10

XVROC-G

Male connector round body BSPP & metric thread

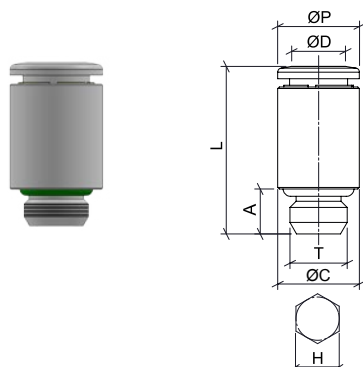

CODE	ØD	T	ØP	ØC	A	L	H
XVROC04M5	4	M5x0,8	10	10	4	19	2,5
XVROC04M7		M7x1	10	10	5,5	20,5	2,5
* XVROC06M7C	6	M7x1	10	10	5,5	20,5	4
XVROC06G01		G 1/8"	12	14	5,5	19,5	4
XVROC08G01		G 1/8"	14	14	5,5	24,5	5

* compact version

XVRCF-G

Female connector BSPP thread

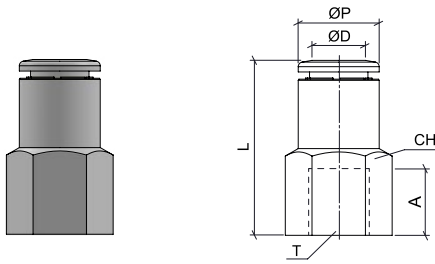

CODE	ØD	T	ØP	A	L	CH
XVRCF04G01	4	G 1/8"	10	7,5	24,5	13
XVRCF06G01	6	G 1/8"	12	7,5	27	13
XVRCF08G02	8	G 1/4"	14	11	30	16

XVRMM

Bulkhead connector

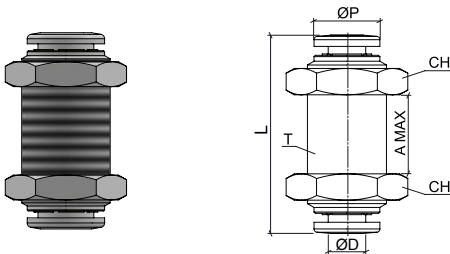

CODE	ØD	T	ØP	A (MAX)	L	CH
XVRMM04	4	M12x1	10	12	30	16
XVRMM06	6	M14x1	12	15	35,5	17
XVRMM08	8	M16x1	14	16	36,5	19
XVRMM10	10	M20x1	16	19	43	24
XVRMM12	12	M22x1,5	19	20	44	25

XVRL-R

Swivel male elbow BSPT thread

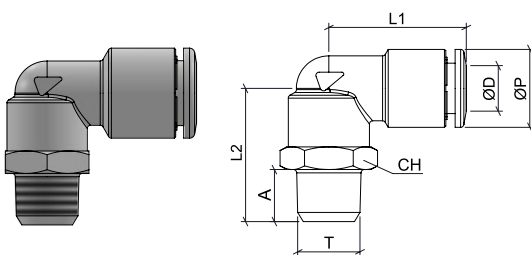

CODE	ØD	T	ØP	A	L1	L2	CH
XVRL04R01	4	R 1/8"	10	8	19,5	20,5	13
XVRL04R02		R 1/4"	10	10	19,5	23	14
XVRL06R01	6	R 1/8"	12	8	21	20,5	13
XVRL06R02		R 1/4"	12	10	21	23	14
XVRL08R01	8	R 1/8"	14	8	23	20,5	14
XVRL08R02		R 1/4"	14	10	23	23	14
XVRL08R03		R 3/8"	14	11	23	24,5	17
XVRL10R02	10	R 1/4"	16	10	26	25,5	16
XVRL10R03		R 3/8"	16	11	26	27	17
XVRL12R02	12	R 1/4"	19	10	31	28	20
XVRL12R03		R 3/8"	19	11	31	28,5	20
XVRL12R04		R 1/2"	19	14	31	31,5	22



XVRL-G

Swivel male elbow BSPP & metric thread

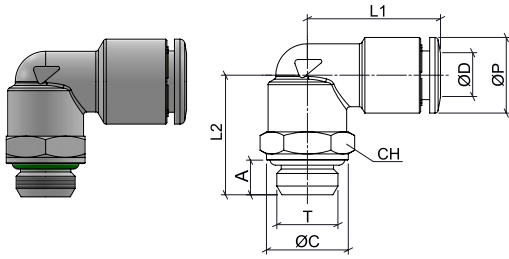

CODE	ØD	T	ØP	ØC	A	L1	L2	CH
XVRL04M5	4	M5x0,8	10	7	4	18	16,5	8
XVRL04G01		G 1/8"	10	13	5,5	19,5	19	13
XVRL04G02		G 1/4"	10	16	6,5	19,5	21,5	13
XVRL06M5	6	M5x0,8	12	7	4	21	16,5	8
XVRL06G01		G 1/8"	12	13	5,5	21	19	13
XVRL06G02		G 1/4"	12	16	6,5	21	21	16
XVRL08G01	8	G 1/8"	14	13	5,5	23	19	13
XVRL08G02		G 1/4"	14	16	6,5	23	21	16
XVRL08G03		G 3/8"	14	20	7,5	23	23	20
XVRL10G02	10	G 1/4"	16	16	6,5	26	23	16
XVRL10G03		G 3/8"	16	20	7,5	26	26	20
XVRL12G02	12	G 1/4"	19	16	6,5	31	25,5	20
XVRL12G03		G 3/8"	19	20	7,5	31	29	20
XVRL12G04		G 1/2"	19	25	9	31	29	25

XVRT-R

Swivel male tee BSPT thread

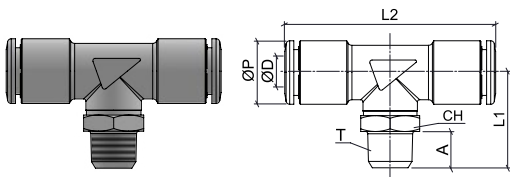

CODE	ØD	T	ØP	A	L1	L2	CH
XVRT04R01	4	R 1/8"	10	8	21	39	13
XVRT06R01	6	R 1/8"	12	8	21	42	13
XVRT06R02		R 1/4"	12	10	23,5	42	14
XVRT08R01	8	R 1/8"	14	8	21	46,5	13
XVRT08R02		R 1/4"	14	10	23,5	46,5	14

XVRT-G

Swivel male tee BSPP & metric thread

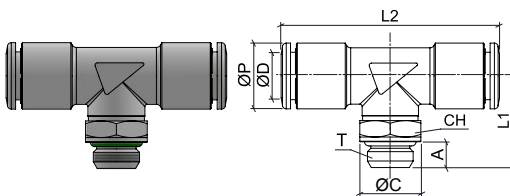

CODE	ØD	T	ØP	ØC	A	L1	L2	CH
XVRT04M5	4	M5x0,8	10	7	4	17	32	8
XVRT04G01		G 1/8"	10	13	5,5	19,5	39	13
XVRT06M5	6	M5x0,8	12	7	4	17	40	8
XVRT06G01		G 1/8"	12	13	5,5	19,5	42	13
XVRT06G02		G 1/4"	12	16	6,5	22	42	16
XVRT08G01	8	G 1/8"	14	13	5,5	19,5	46,5	13
XVRT08G02		G 1/4"	14	16	6,5	22	46,5	16
XVRT10G02	10	G 1/4"	16	16	6,5	23	52	16
XVRT10G03		G 3/8"	16	20	7,5	26	52	20
XVRT12G03	12	G 3/8"	19	20	7,5	26,5	62	20
XVRT12G04		G 1/2"	19	25	9	29	62	25

XVRA-G

Stem adapter BSPP thread

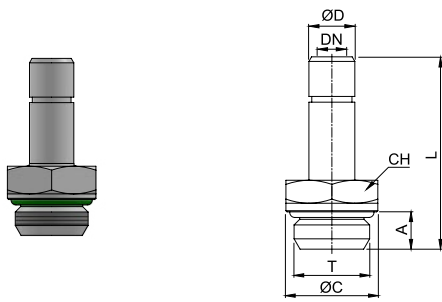

CODE	ØD	T	ØC	A	L	DN	CH
XVRA04G01	4	G 1/8"	13	5,5	27,0	2	13
XVRA06G01	6	G 1/8"	13	5,5	28,0	4	13
XVRA06G02		G 1/4"	16	6,5	30,5	4	16
XVRA08G01	8	G 1/8"	13	5,5	29,5	6	13
XVRA08G02		G 1/4"	16	6,5	32,0	6	16
XVRA10G02	10	G 1/4"	16	6,5	36,5	8	16
XVRA12G03	12	G 3/8"	20	7,5	38,5	10	20

XVRUC

Union connector

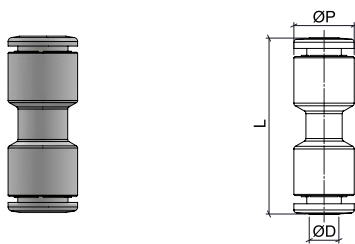

CODE	ØD	ØP	L
XVRUC04	4	10	29
XVRUC06	6	12	32
XVRUC08	8	14	35,5
XVRUC10	10	16	39,5
XVRUC12	12	19	44

XVRG

Reduced union connector

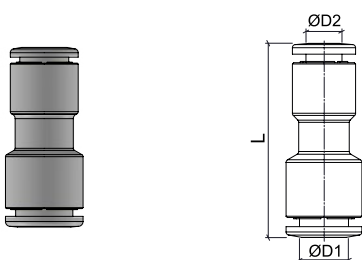

CODE	ØD1	ØD2	L
XVRG0604	6	4	30,5
XVRG0806	8	6	34
XVRG1008	10	8	37
XVRG1210	12	10	41,5



XVRUL

Union elbow

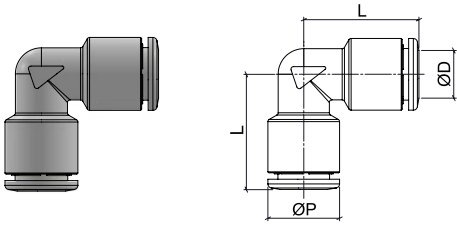

CODE	ØD	ØP	L
XVRUL04	4	10	16,5
XVRUL06	6	12	20,5
XVRUL08	8	14	22,5
XVRUL10	10	16	25
XVRUL12	12	19	29

XVRUT

Union tee

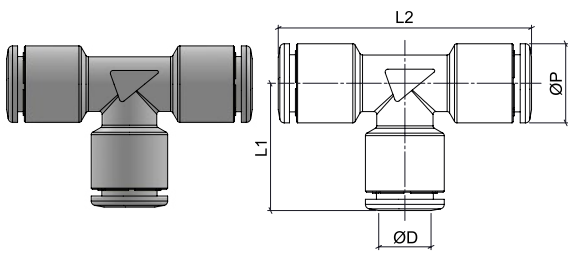

CODE	ØD	ØP	L1	L2
XVRUT04	4	10	16,5	33
XVRUT06	6	12	20,5	41
XVRUT08	8	14	22,5	45
XVRUT10	10	16	25	50,5
XVRUT12	12	19	29	58

XVRGJ

Stem reduction

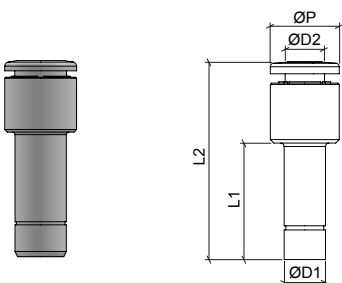

CODE	ØD1	ØD2	ØP	L1	L2
XVRGJ0604	6	4	10	17	28,5
XVRGJ0806	8	6	12	19,5	32,5
XVRGJ1006	10	6	10	24	37
XVRGJ1008	10	8	14	24	38



